

APARTMENT DRAWINGS

AURA
STUDIO

APPLICABLE FOR UNIT 8

Typical developments have electric layouts with very few points, not keeping in mind the increasing needs of the modern world. What's even worse is that very little thought is put into the location and user-friendliness of the various switches and sockets in a home - leading to problematic situations when you start doing your interiors. At Nexworld, we have gone above and beyond - provisioning for all kinds of possibilities and carefully detailing out the locations of the various points.

Living Room:
A carefully planned lighting grid means you won't need a false ceiling. We've even provisioned for floor lamps in the corners of the living room - something that's missed out even in very high end developments.

Kitchen:
Modern kitchens tend to have a lot of different appliances for which there are 4 different socket positions distributed all over the kitchen, with a lot of blanks in case you want even more plug points.

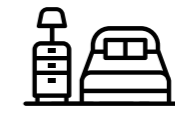

Bedroom:
We've provisioned for each side of the bed to have at least 2 plug points to take care of the increasing number of personal gadgets. There are provisions for a dedicated light for your desk and cupboard too.

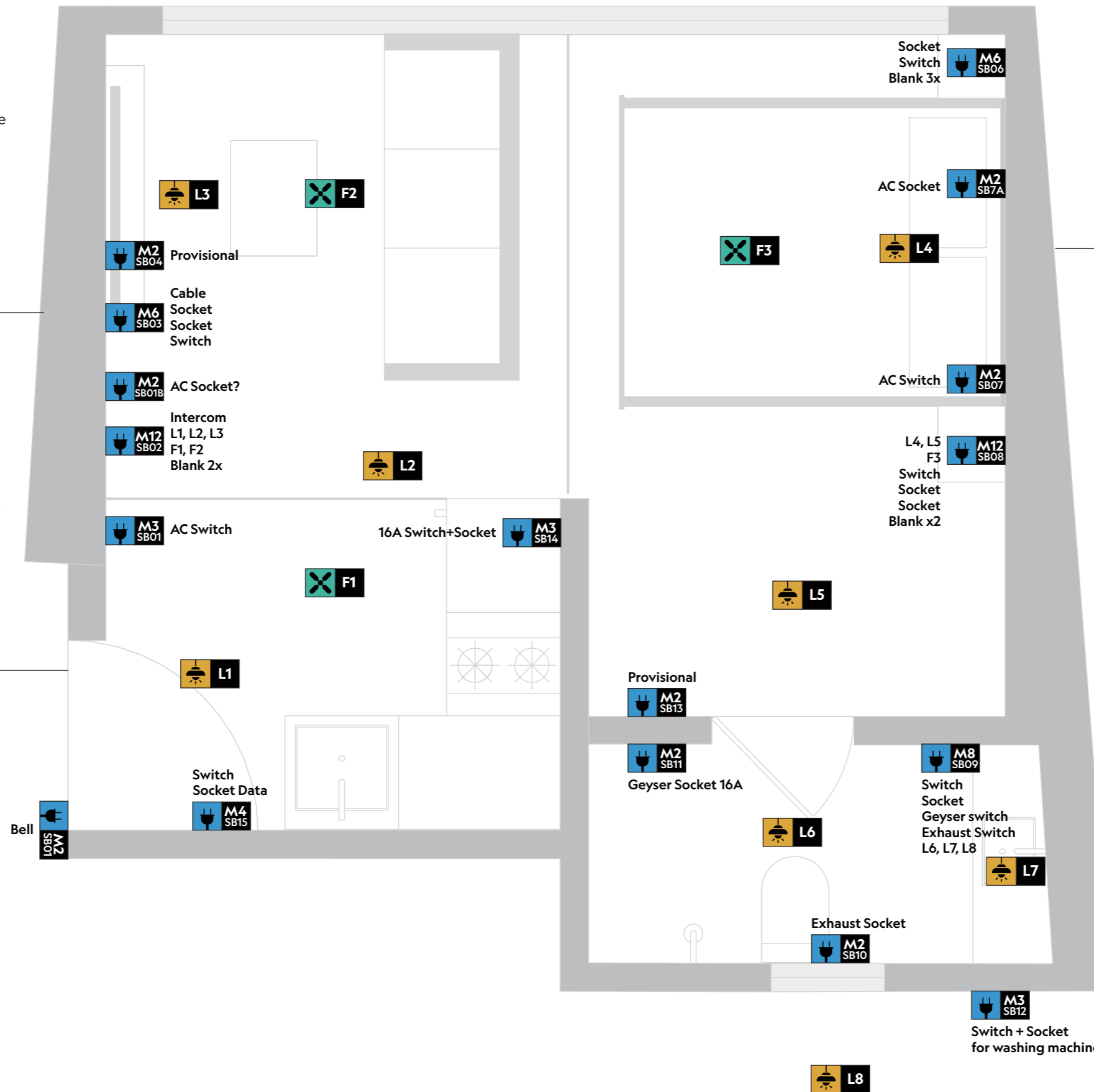

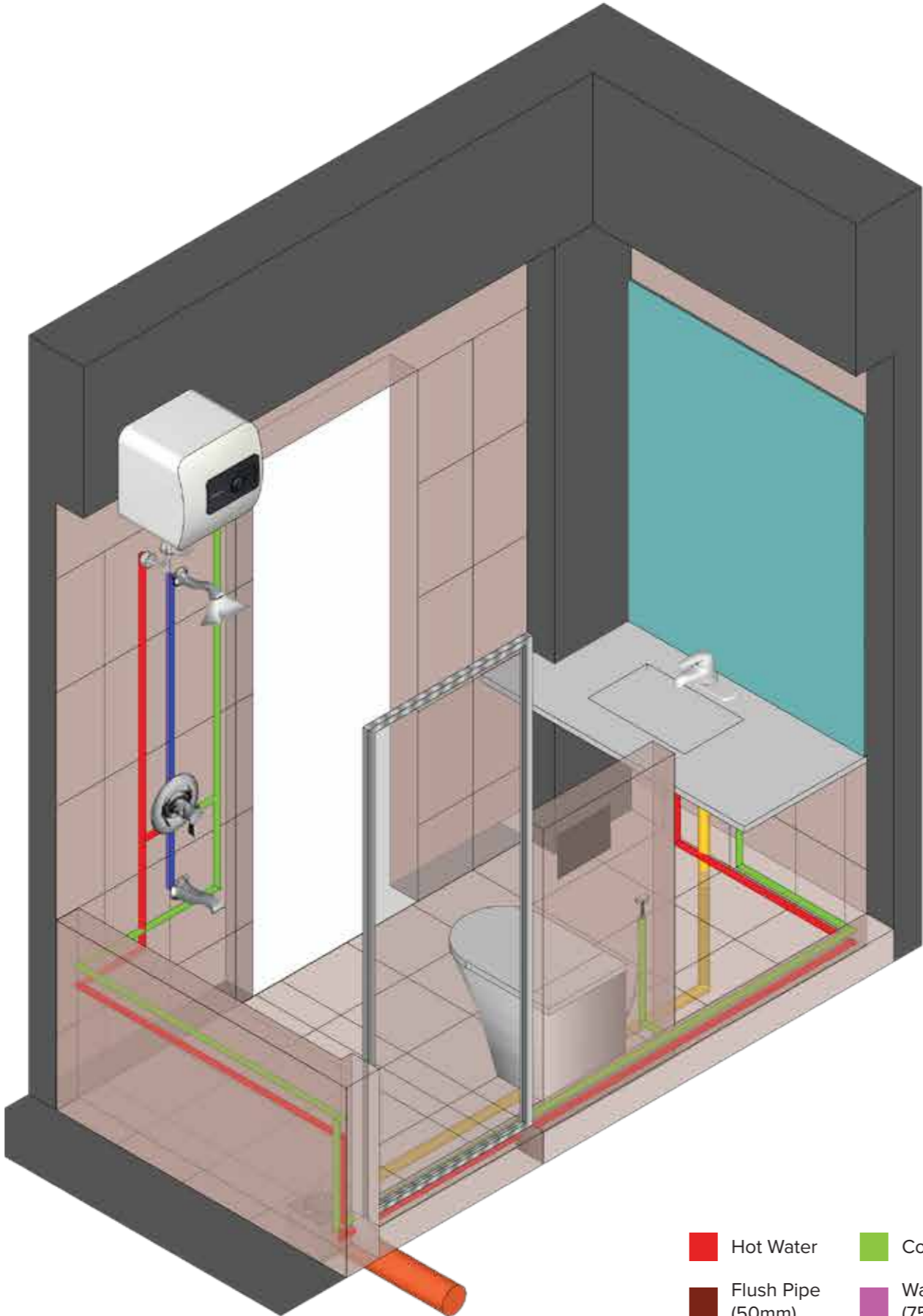

- Hot Water
- Cold Water
- Hot + Cold Water
- Waste Water Pipe (40mm)
- Flush Pipe (50mm)
- Waste Water Pipe (75mm)
- Waste Water Pipe (110mm)

